



Dimension: 215 × 69 × 43mm

Features:

- Constant voltage design
- 180~264VAC input range
- Small volume, low weight, high efficiency
- Protections : short circuit/over load/over voltage/over temp
- Cooling by free air convection
- Fully encapsulated with IP67 level
- 100% full load burn-in test
- 2 Years warranty



SPECIFICATION

| FAX - 120-12V | | | | | FAX - 120-24V | | FAX - 120-36V | |
|---------------|---------------------------|---|--|--------------|---------------|------------|---------------|--|
| Output | DC voltage | 12V | | 24V | | 36V | | |
| | Voltage tolerance | ± 3% | | ± 2% | | ± 2% | | |
| | Rated current | 10A | | 5A | | 3.3A | | |
| | Current range | 0 ~ 10A | | 0 ~ 5A | | 0 ~ 3.3A | | |
| | Rated power | 120W | | 120W | | 119W | | |
| | Ripple&noise | 100mVp-p | | 150mVp-p | | 150mVp-p | | |
| | Setup, rise, hold up time | 800ms,36ms,20ms/230VAC | | | | | | |
| Input | Voltage range | 180 ~ 264VAC 47 ~ 63Hz, 255 ~ 373VDC | | | | | | |
| | AC current | 1.5A/230VAC | | | | | | |
| | Efficiency | 82% | | 84% | | 85% | | |
| | Inrush current | Cold start40A/230VAC | | | | | | |
| | leakage current | < 2.5mA/240VAC | | | | | | |
| Protection | Overload | Rated output power105% ~ 135%Start overload protection | | | | | | |
| | | Protection type: hiccup mode, auto-recovery after fault condition is removed | | | | | | |
| | Over voltage | 15.8 ~ 18V | | 30.6 ~ 33.6V | | 44 ~ 48.6V | | |
| | | Protection type: hiccup mode, auto-recovery after fault condition is removed | | | | | | |
| | Over temperature | Case temp≥85℃ ± 5℃, Start over temp protection | | | | | | |
| | | Protection mode: cutoff output, auto-recovery after temperature become normal | | | | | | |
| Environment | Working temp, humidity | -20℃ ~ +60℃;20% ~ 90%RH(Please refer to “derating curve”) | | | | | | |
| | Storage temp, humidity | -40℃ ~ +85℃;10% ~ 95%RH Non-condensing | | | | | | |
| | Withstand vibration | 10 ~ 500Hz, 5G 10min./1Cycle, Period for 60min, Each axes | | | | | | |
| Safety | Withstand voltage | I/P-O/P: 1.5KVAC I/P-FG: 1.5KVAC O/P-FG: 0.5KVAC | | | | | | |
| | Isolation resistance | I/P-O/P: I/P-FG,O/P-FG: 100M Ohms/500VDC | | | | | | |
| Fit standard | Safety standard | Compliance to IEC60950-1,UL60950, EN60950-1,IEC61347-1,UL61347,EN61347-1 | | | | | | |
| | EMC Standard | Compliance to EN55015(CISPR22)Class A, GB9254 Class A,EN55014,EN61000-3-2,3 | | | | | | |
| Others | MTBF | 670K hrs min. MIL-HDBK-217F(25℃) | | | | | | |
| | Weight/Dimension | 215*69*43mm (L*W*H) | | | | | | |
| | Packing | 1.1kg/20pcs/22kg/0.03m³/1.07CUFT | | | | | | |

Note: 1. All parameters NOT specially mentioned are measured at 230VAC input, rated load and 25°C of ambient temperature.

2. Ripple & noise are measured at 20MHz of bandwidth by using a 12" twisted pair-wire terminated with a 0.1uf & 47uf parallel capacitor.

3. Tolerance : includes set up tolerance, line regulation and load regulation.

Unit:mm

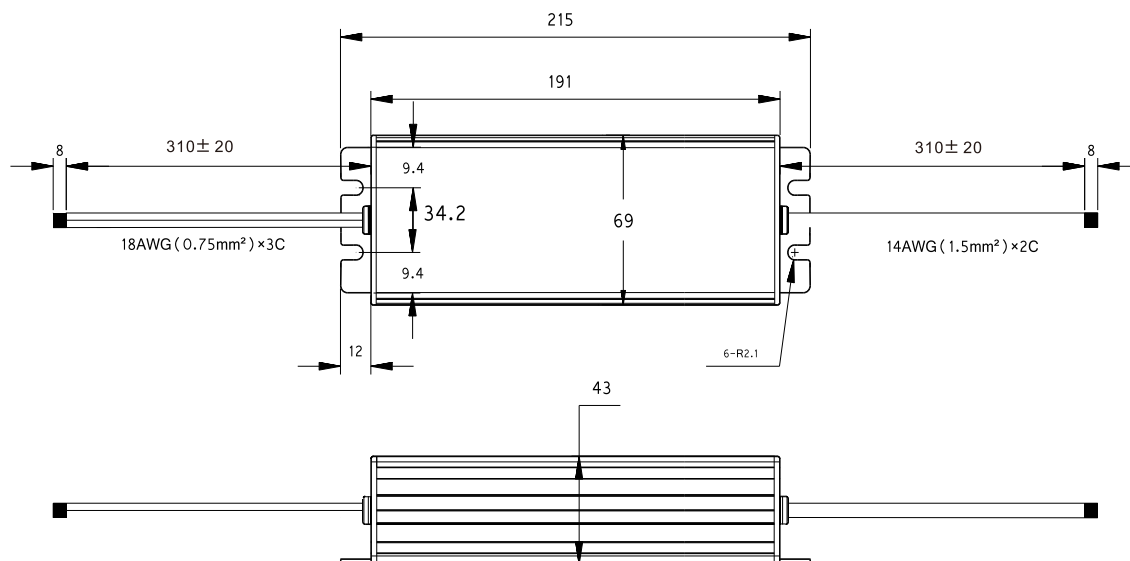

| Input(Black three-core) | | Output (White two-core) | |
|-------------------------|------------|-------------------------|--------------|
| Brown | AC/L | Red | DC OUTPUT +V |
| Blue | AC/N | Black | DC OUTPUT -V |
| Yellow-green | FG \perp | | |

